

Dektite® installation instructions



1
Cut Dektite® cone where indicated for the relevant pipe size



2
Slide Dektite® flashing down over pipe. Water can be used as a lubricant



3
Apply neutral cure silicone sealant on underside of flange



4
Press pipe flashing into contours of roof panel

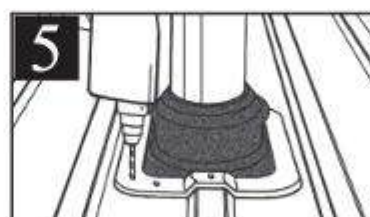

5
Fasten flashing to surface with self-tapping or self drilling screws; or selected pop rivets

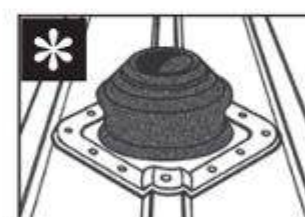

Use a Dektite® on the 'diamond' or bias for enlarged holes and penetrations on steep pitched roofs or deep contours

